

# LumiraDx Platform User Manual Addendum for Use with the LumiraDx SARS-CoV-2 Ag Surveillance Test

The LumiraDx Instrument can be used for surveillance testing for the detection of SARS-CoV-2 nucleocapsid protein in de-identified specimens with the LumiraDx SARS-CoV-2 Ag Surveillance Test.

For complete instructions on how to use the LumiraDx Instrument, please see the LumiraDx Platform User manual which comes with your Instrument and is also available at lumiradx.com. The Platform User Manual includes information about setting up your Instrument for first time use.

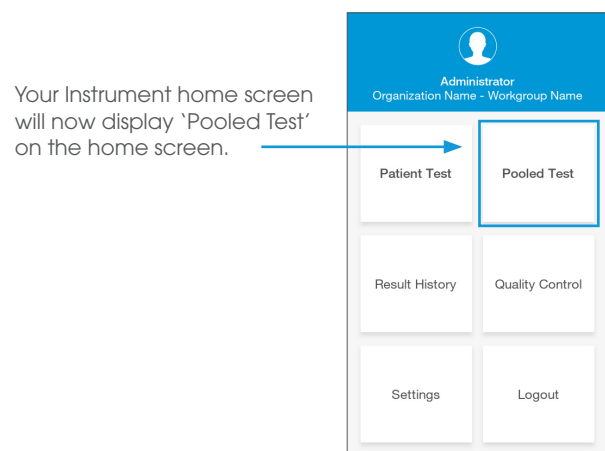
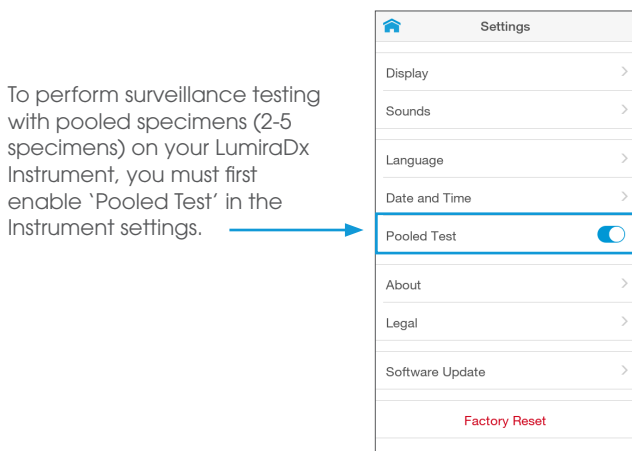

## Performing a Surveillance Test:

1. To perform surveillance testing using a single specimen, select "Patient Test" on the home screen.
2. To perform surveillance testing with pooled specimens (2-5 specimens), select "Pooled Test" on the home screen.

Please see the LumiraDx SARS-CoV-2 Ag Surveillance Test Product Insert and Quick Reference Instructions for full instructions on how to perform a SARS-CoV-2 Ag Surveillance Test.

## About The LumiraDx SARS-CoV-2 Ag Surveillance Test:

The LumiraDx SARS-CoV-2 Ag Surveillance Test has not been cleared, approved, or authorized by FDA under an emergency use authorization (EUA). This test should be used for surveillance purposes (i.e., to inform population or community-level decision-making) only. FDA does not regulate surveillance tests.

### Manufacturer Information:

LumiraDx UK Ltd  
Dumyat Business Park  
Alloa FK10 2PB, UK

Registration Number: 09206123

### Customer Services:

If the LumiraDx SARS-CoV-2 Ag Surveillance Test or the LumiraDx Instrument do not perform as expected, contact LumiraDx Customer Services at 1-888-586-4721 or customerservices.us@lumiradx.com

Copyright © 2021 LumiraDx UK and affiliates. All rights reserved. LumiraDx and Flame logo are protected trademarks of LumiraDx International LTD. Full details of these and other registrations of LumiraDx can be found at lumiradx.com/IP. All other trademarks are the property of their respective owners.